

How to take care of the device

Daily care <Dirt removal, cleaning → disinfecting → rinsing → drying>

How to remove the handle

Remove the handle from the receiver in order to wash it.

- 1 Remove the inner receiver and the hose.

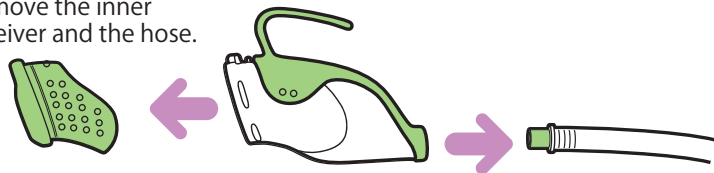

- 2 Remove the handle from the side connected to the tube



- 3 Remove the handle
- When assembling the device, assemble the tube and inner receiver after attaching the handle to the receiver.

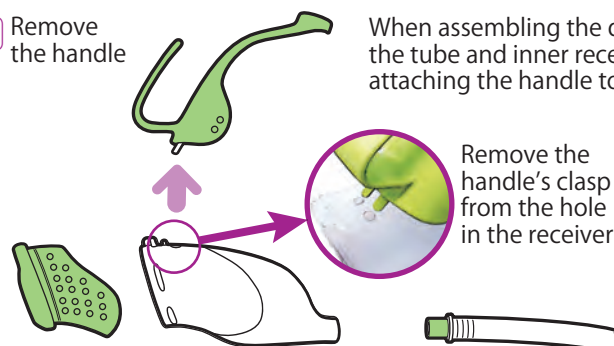

Remove the handle's clasp from the hole in the receiver



↑ See here for more details

Dirt removal, cleaning

【Receiver, urine tube】

Disassemble the inner and outer receivers before cleaning.

- 1 Fill a bath bowl or a similar container with lukewarm water, add to it neutral toilet detergent and let the device soak.



- 2 Remove any dirt with a soft sponge



- 3 Rinse with water



【Urine collection tank】

Insert water, shake in all directions, and rinse out.

※ If it is especially dirty, please use a cleaning brush.

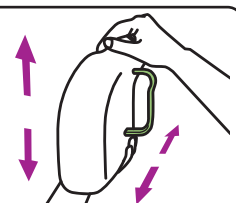

Disinfecting

Disinfect the receiver with a commercially available alcohol-based disinfectant.

Rinsing/drying

Rinse well with cold or lukewarm water and dry thoroughly in a shaded area.

Cleaning when particularly dirty

When impurities like urinary stones or protein particles are attached to the device after prolonged use, soak in citric acid solution (about 5%) for about 20 minutes to remove them and then wash thoroughly. Commercially available tablets for urine bottles can also be used.

Name of each component / contents of set

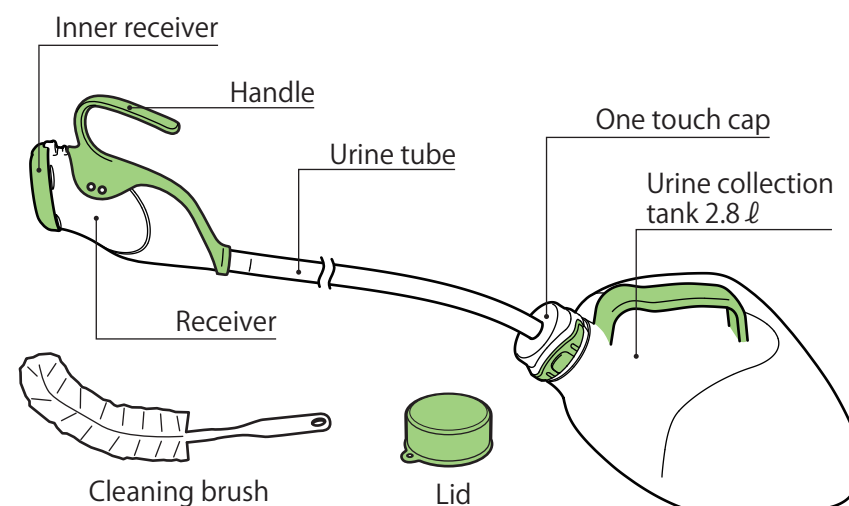

Materials

- Receiver : silicone
- Cap : polyacetal (POM)
- Handle : polyacetal (POM)
- Tube : polyvinyl chloride (PVC)
- Urine collection tank : polyethylene
- Lid : silicone

Notes of caution



Before using the product, be sure to read this manual and fully understand its content.

- If redness, etc. is observed on the skin, please cease use immediately.
- Until you get used to using the product, please lay out disposable absorptive sheets, etc. under the person's lower back and practice to avoid leaks.
- To prevent the propagation of bacteria and mold that can lead to odor and infection, take sufficient care in sanitizing the product by washing, sanitizing, and drying the parts, etc. Also, reusing on other people is prohibited.
- There are individual differences in the way the product is presented and reproduced and we do not necessarily guarantee individual benefits or effects.
- We are not responsible for any physical injuries or other damages if this product is used in a manner other than that recommended by our company.
- We will not offer assistance in case of problems resulting from using this product after modifying it in any way.
- In order to guarantee the adequate flow of urine, make sure that there is a difference in height between the receiver and the urine collection tank.
- Avoid exposure to direct sunlight and store in a dry place at room temperature.



Asahi Industry Co., Ltd.

Asahi Industry produces a new urination care product
1-11-22 Yonban, Atsuta, Nagoya, Aichi, Japan
TEL: +81-52-671-5193 FAX: +81-52-671-5196
For more information / Healthcare division: info_e@asahi-sg.co.jp
<https://asahi-packaging.com>

Men's hand-held urine collector

AS-TUR010

Usage Guide

In order to use the device comfortably, it is important to understand and become familiar with its characteristics. It's important to understand how to use the device correctly and become able to urinate independently.



Before using the product, please read this instruction manual carefully and fully understand how to use the device correctly.

Basic operation



As a precautionary measure, until you become familiar with the device, we recommend protecting the bedding by covering it with waterproof sheets or the like.

1 Face-up position

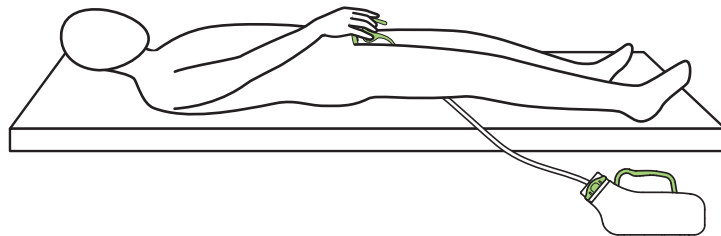

2 On-one-side position

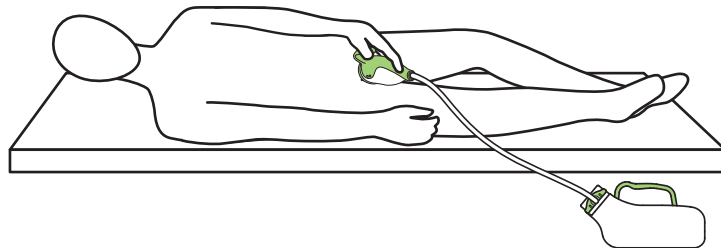

3 Sitting upright position

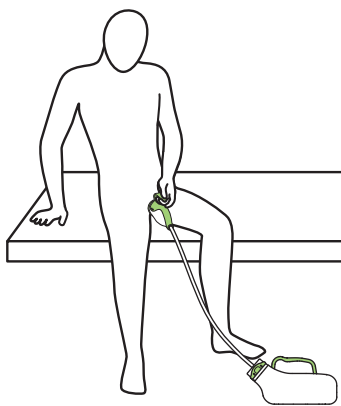

4 Knee gatch position

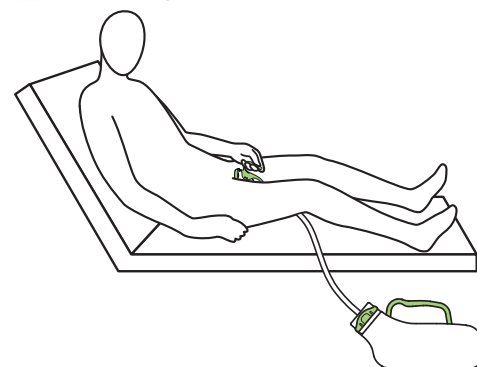

5 Standing position (next to bed)

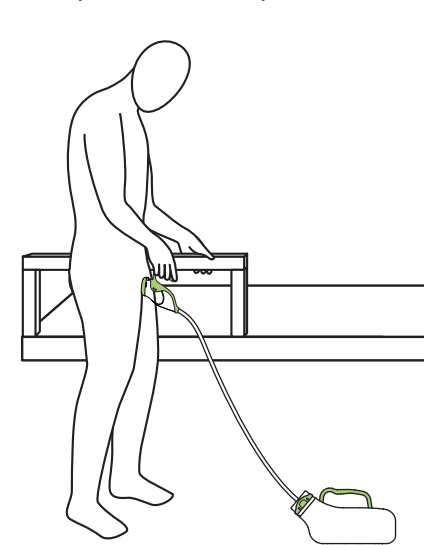

6 Sitting position (in wheelchair)

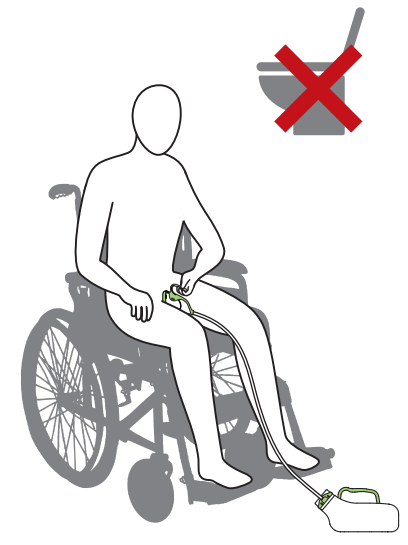

Adjusting the tube's length

How to insert the tube

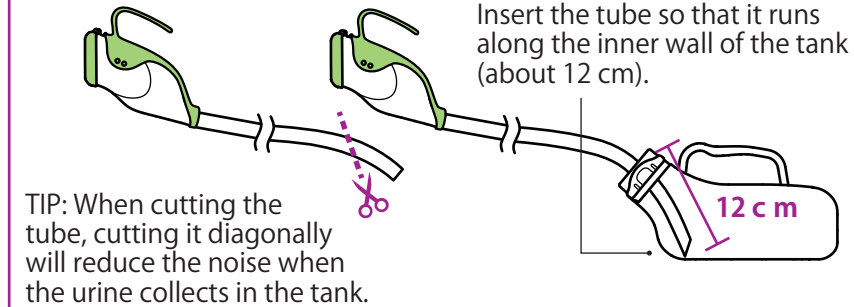

How to ensure the difference in height between the two ends of the tube

Difference in height

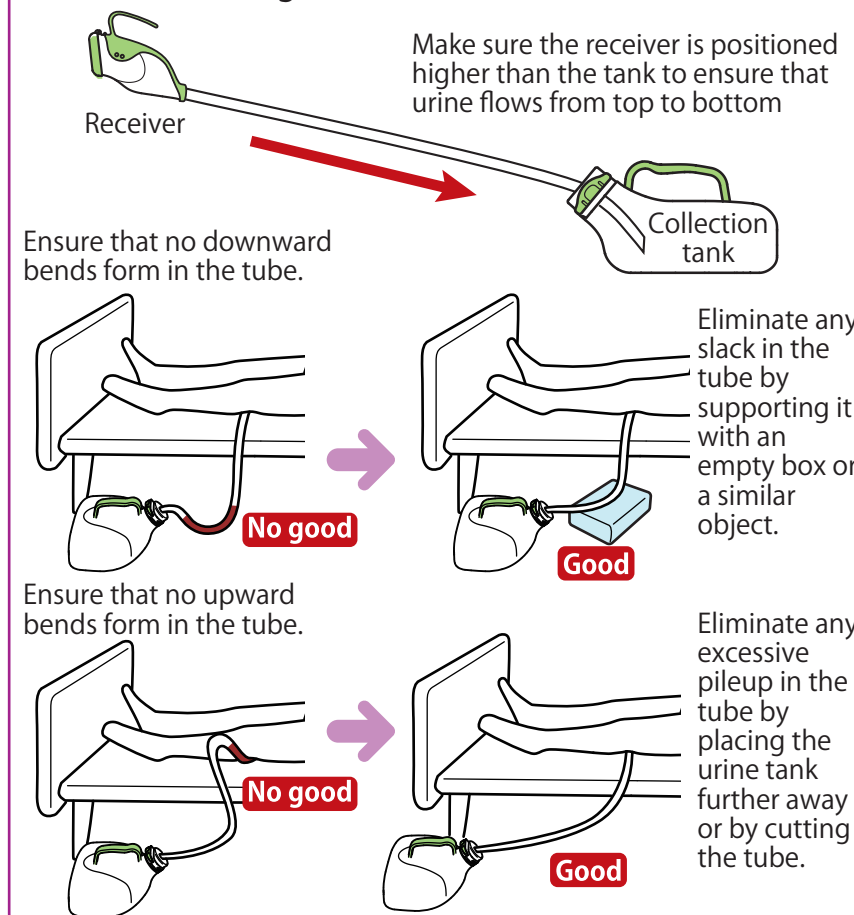

How to fit the receiver

Insert the receiver all the way to the base of the penis.

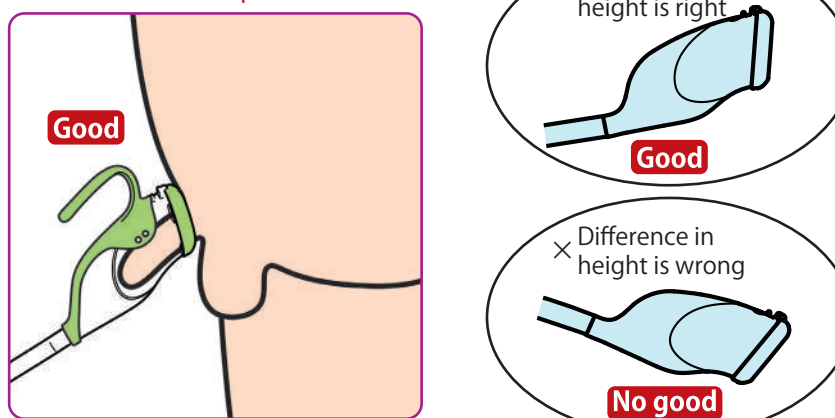

How to hold the receiver

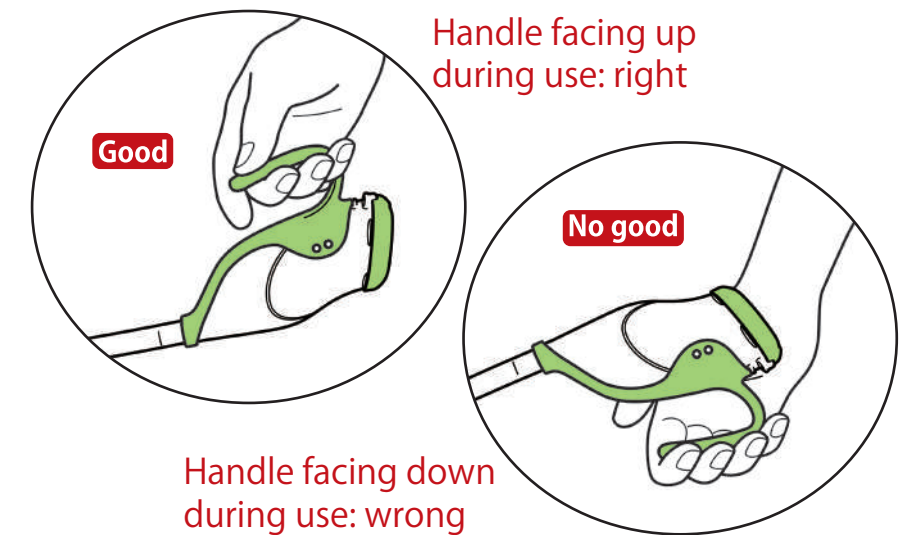

How to use the lid

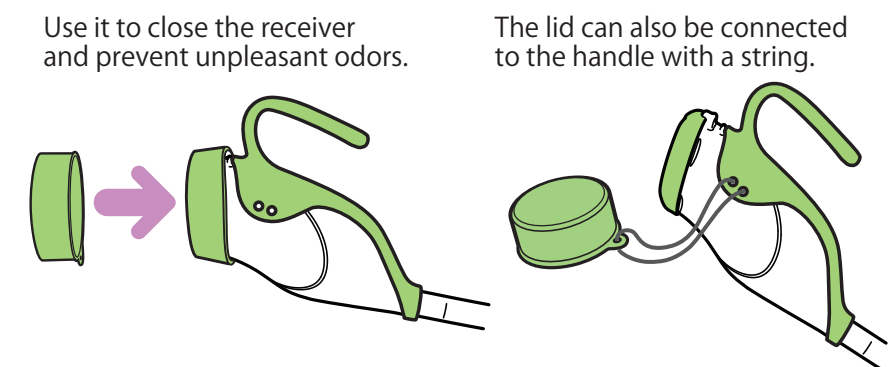

If wearing the device all the time

