

Names of each part and included accessories

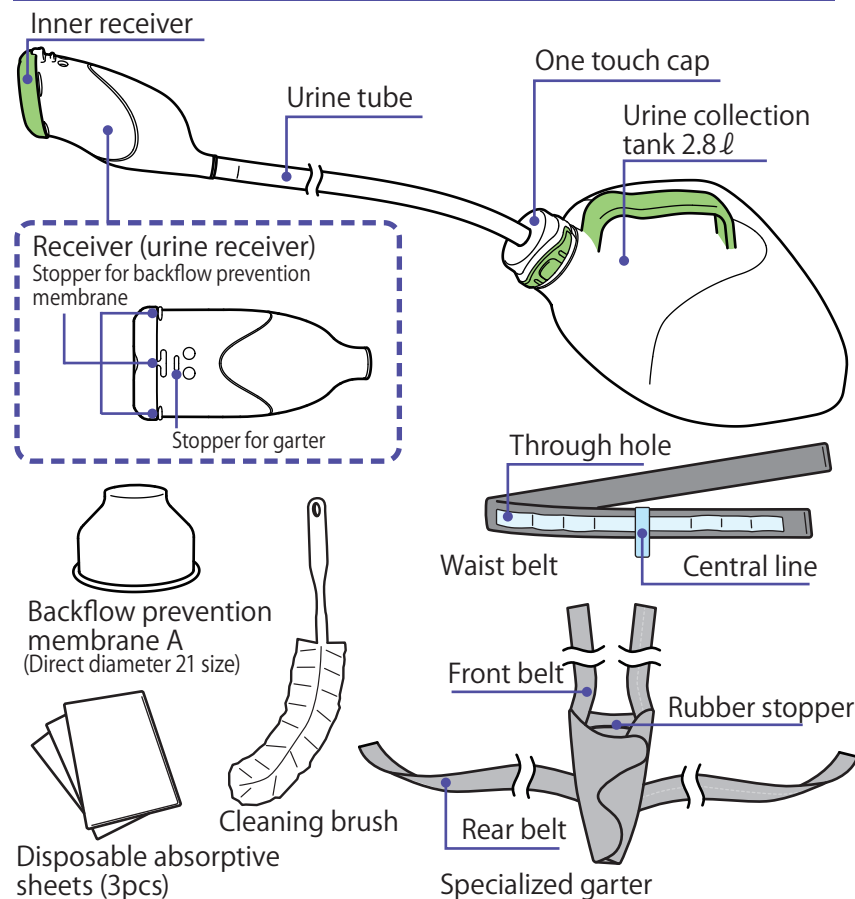

Tube length adjustment and tube insertion methods

The tube is included with a length of 150cm. Referring to [Table 1] below, please cut it to the appropriate length and insert it into the tank. [Figure 1]

■ Bed

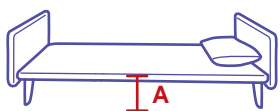

■ Futon



[Table 1] Tube length reference

| Height of bedding surface (A) | Tube length |
|-------------------------------|-------------|
| ① About 15cm | 97 ~ 105cm |
| ② About 40cm | 105 ~ 113cm |
| ③ About 50cm | 115 ~ 123cm |
| ④ About 60cm | 130 ~ 138cm |

[Figure 1] Tube insertion method

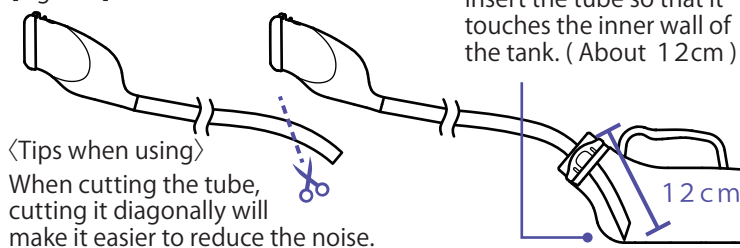

About the installation of the receiver

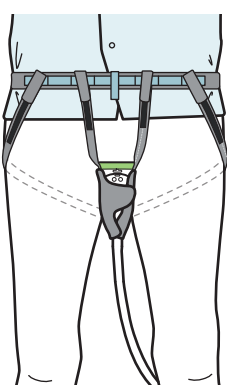

< Tips when using >

- Equipping the waist belt on top of a shirt or underwear will reduce the burden on the skin.
- Please make sure not to pull the belt too forcefully in the front or back.
- Prepare slightly large underwear and pants that will be work over the device and avoid excessive bending or folding of the tube. In some cases you may be able to improve urine flow by cutting a notch in underwear or pants.

How to maintain < dirt removal washing → sterilization → rinsing → drying >

Please be sure to perform maintenance every day.

● Dirt removal washing

【 Receiver tube 】 ※ Please disassemble the inner and outer receiver tubes.

- 1 Draw tepid water into a bath tub, etc., and let it soak for a while in a mixture of water and mild toilet detergent
- 2 Remove dirt with a soft sponge
- 3 Rinse off with water

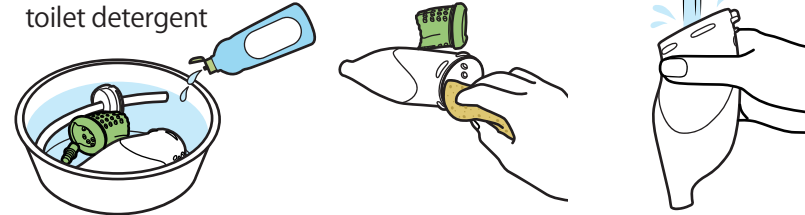

【 Urine collection tank 】

Insert water, shake in all directions, and rinse out.
※ If it is especially dirty, please use a cleaning brush.

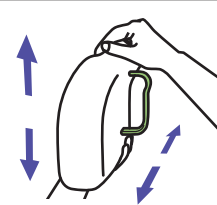

【 Garter 】

Hand wash with detergent, then leave out in the shade to dry.

● Sterilization

Please sterilize inside the receiver using a commercially available alcohol-based disinfectant.

● Rinsing and drying

Rinse well with cold or tepid water, then allow to dry completely in the shade.

● When dirt is visible

Long term use can lead to urinary stones, protein, etc. to build up. In such cases please remove the dirt by soaking for about 20 minutes in a solution of citric acid (about 5%) and then washing. You can also use commercially available urinal tablets.

Materials

- Receiver/silicone
- Tube/PVC
- Tank/Polyethylene
- Cap/Polyacetal (POM)
- Backflow prevention membrane/latex

Warranty and returns

※ Returning and exchanging products

For hygienic purposes, products which have been used or worn cannot be returned.

Notes of caution



- If redness, etc. is observed on the skin, please cease use immediately.
- Until you get used to using the product, please lay out the provided disposable absorbent sheets, etc. under the person's lower back and practice to avoid leaks.
- If worn for long periods of time, it could result in steamed and it may hurt the skin. Please remove the receiver once or twice a day to clean and sanitize the area.
- To prevent the propagation of bacteria and mold that can lead to odor and infection, take sufficient care in sanitizing the product by washing, sanitizing, and drying the parts, etc. Also, reusing on other people is prohibited.
- Please use lying down (facing up or to the side).
- The expressions displayed on this product and the reproducibility of effects will vary by person, and do not necessarily constitute a guarantee of benefits or effects.
- We cannot provide support for problems occurring when this product is used with modifications, alterations, etc. added.
- In order to ensure urine flow, please mount with the height difference between the receiver and the urine collection tank.
- Store out if direct sunlight at room temperature in a dry place.

Men's wearable urine collector for sleeping position

AS-DUR010

Usage Guide

For comfortable use of this product, it is important to understand its features and how to use it correctly. You will have to adjust the location for attaching the device depending on your body frame and type. It is important to use the device according to your body. Even if you have a leak when you first start using it, it is important to continue using it until you learn and devising how to use it well to urinate.



The device is mainly meant to be used in a lying position



Before using the device, be sure to read this manual and fully understand its content. Please keep this manual handy for future reference.

Asahi Industry Co., Ltd.

1-11-22, YONBAN, ATSUTA-KU, NAGOYA, AICHI
TEL +81-52-671-5193 FAX +81-52-671-5196
asahi-packaging.com

Basic way to use



When using

- Until you get used to using the product, please lay out the provided disposable absorptive sheets under the person to avoid getting bedding dirty in the case of an accident.
- If worn for long periods of time, it could result in steamed and it may hurt the skin. Please remove the receiver once or twice a day, wipe the penis with lukewarm water, dry, and perform skin care.
- The urine collector cannot be used for those who will remove it from themselves or those with forceful body movements.

- ★ Make sure the tank and receiver air holes are not blocked

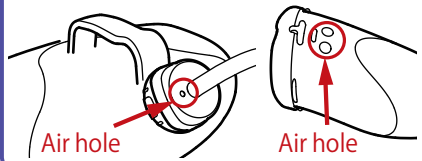

Pass the tube behind the knees, and lay a towel between the tube and the knee

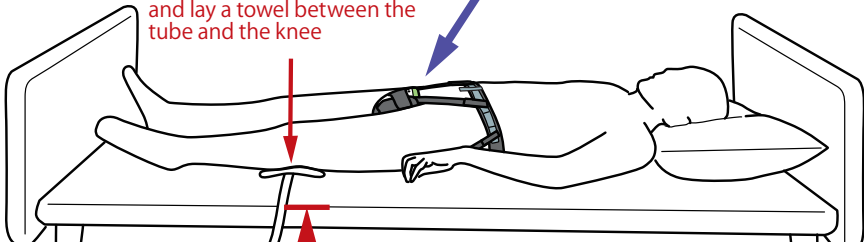

Height difference of **15 cm** or more

- ★ Make sure a height difference of 15cm or more is secured between the floor and the tube.

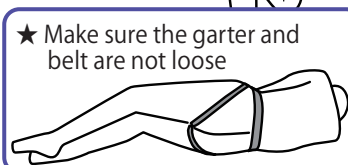

This urine collector requires a smooth flow of urine from the receiver to the tank. Before use, please make sure you have met all the requirements in [★Points] below.

- ★ Make sure the receiver outlet is not tilted up

- ★ Make sure there are no valley bends in the tube

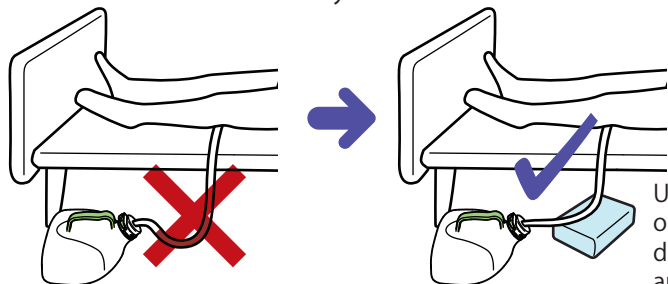

Use an empty box or other object under the tube to fix any valley bends

- ★ Make sure there are no mountain bends in the tube

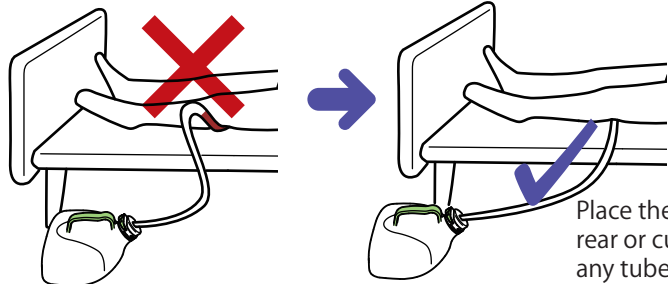

Place the urine tank in the rear or cut the tube to fix any tube mountain bends

Use diagram when sleeping on futon

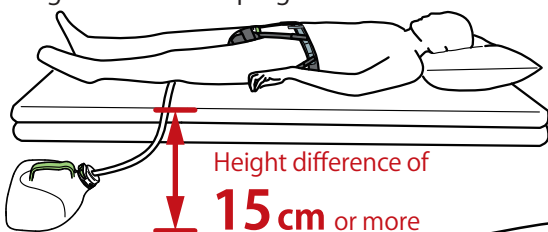

Height difference of **15 cm** or more

Use diagram when lying position

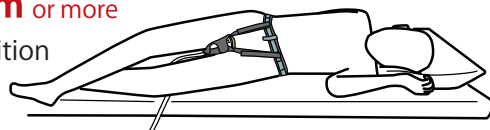

<Tips when using>

When using in a futon, please lay 2 underquilts or lay a mattress underneath the underquilt to secure the 15cm height difference or more.

How to mount the receiver

- 1 Turn the inner fabric of the garter upward

Place it such that the stitched (mark) belt is on the right side

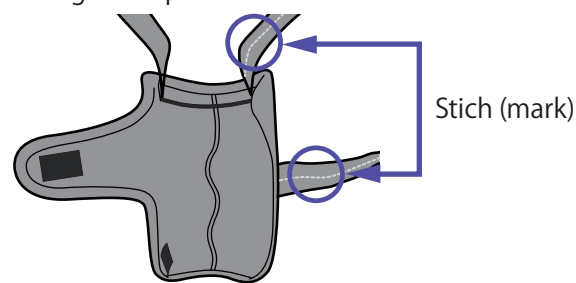

- 2 Hang the anti-slip rubber onto the protrusion on the receiver

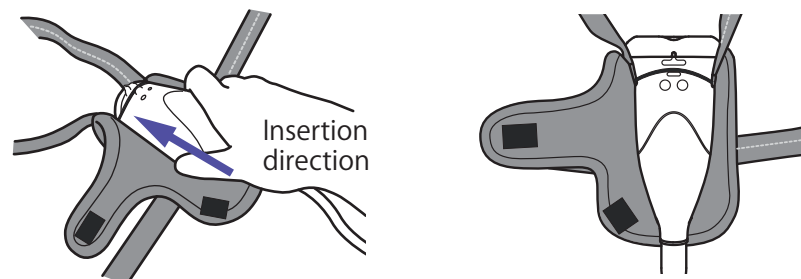

- 3 Close the central and lower surface fastener

※ When doing so, please make sure that the receiver air hole is not blocked.

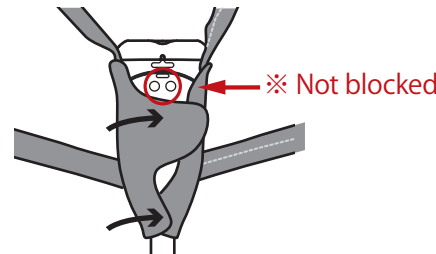

- 4 Mount the belt

Please line up the central line with the navel. If putting it on yourself do so sitting down; if caring for someone else we recommend having the person lie down in a lateral position and spreading the waist belt under them before returning them to the supine position.

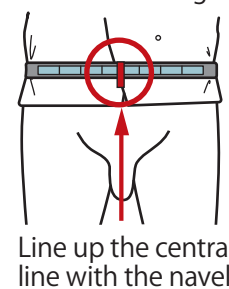

Line up the central line with the navel

If independent



Wearing in a seated position

If providing care

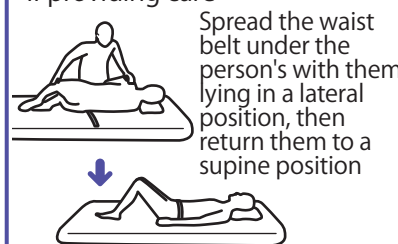

Spread the waist belt under the person's with them lying in a lateral position, then return them to a supine position

- 5 Insert the penis into the receiver

When doing so, please make sure that the penis is not bent. If the penis is bent, it will cause leakage.

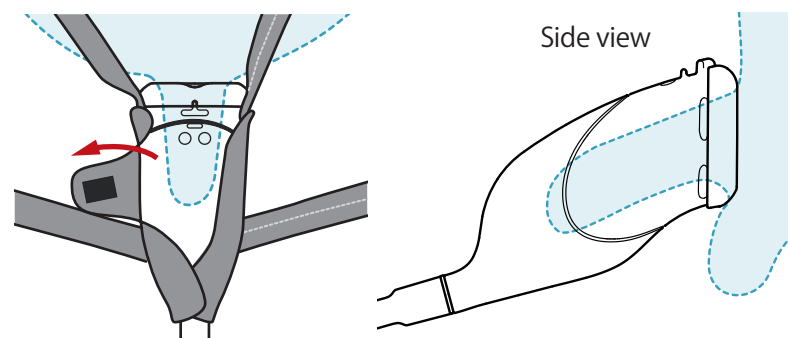

Remove the central surface fastener and check if necessary

- 6 Pass the front belt on the left and right through the through hole on the waist belt (①), and fold the surface fastener back to the best position and fasten it there (②). Fix the belt on the other side in the same way.

※ Please use with the through hole in an easy-to-use position.

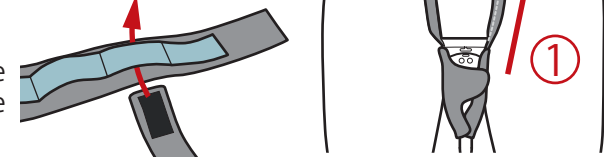

- 7 Raise up one knee, pass the rear belt under the thigh (③), and fix the waist belt with the through hole (④). Fix the belt on the other side in the same way

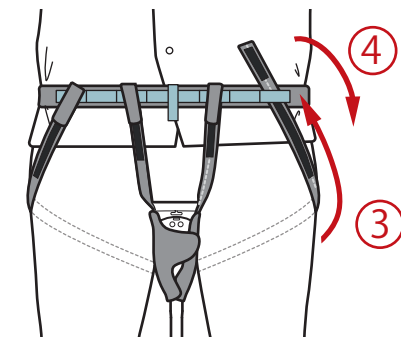

- 8 If you put it on in a seated position, lie down into a sleeping position and make final adjustments to each belt to complete the process.

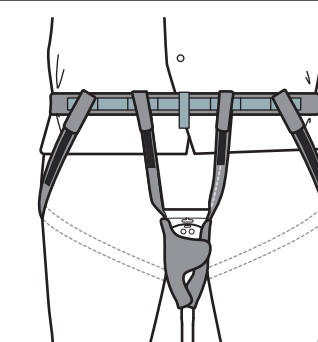

- To those using the backflow prevention membrane

If the person is low mobility you can use with the receiver only. If the person is highly mobile and the penis slips out from the receiver, please attach the backflow prevention membrane to the receiver's retainer when using.

FAQ Frequently asked questions

How do I know when to replace it?

You should replace it when the tube starts to harden and deteriorate. Deterioration will cause leaks. If you wash it frequently and keep it sanitized you can use it for a long time.

What are some tips to avoid leaks?

To enable the urine to flow smoothly, secure the height difference between the receiver and urine tank, and ensure that the tube isn't mashed.

How do I store it when not used for long periods?

Follow the instruction manual on cleaning and drying the product, and then store in a clean location away from high temperature and humidity without bending the tube.

Useful Tip

Apply Vaseline or other lubricant to the rubber O-ring at the mouth of the urine collection bottle for easier attachment and removal.



O-ring